

INDIRA MAHINDRA SCHOOL OF EDUCATION BROCHURE 25-26





About IMSE

The Indira Mahindra School of Education (IMSE) at Mahindra University was established in 2021. Named in memory of Ms. Indira Mahindra who was a teacher (and mother to our Chancellor, Mr. Anand Mahindra and Ms. Anuja Mahindra Sharma, Member Board of Management of Mahindra University, the school aspires to be a center of excellence in educational research, practice, and innovations.

The School is founded on the understanding that education is at the center of transformations, starting from the individual to the Nation at large. The development of IMSE since its inception has been guided by a vision to nurture excellence, prioritize research, and create a mark of its own nationally and internationally.

IMSE offers two programs currently

- » **MA in Education**
- » **Ph.D. in Educational Studies**

The programs are designed to enable students to take up multiple challenging career paths.

The faculty members of the school bring their expertise in research, institution building, teaching, and training that draws on different disciplines and includes partnerships with academic communities, educational institutions, and civic organizations.

As the school expands, we are confident that the synergy of research, teaching and training will become stronger leading to far-reaching impacts.



“

“At Mahindra, we believe the right education has the greatest potential to contribute to economic inclusivity and to a sustainable development which makes our foray into all segments of education very consistent with our Rise philosophy of business”

”

Anand Mahindra

Chancellor- Mahindra University

“

“MU is home to a vibrant group of students from different areas of specialization with a keen aptitude. They have been rigorously imbibing the best of what MU has to offer. They are being groomed to be industry-ready and future-ready individuals in an environment where there is a scope of holistic development.”

”

Dr. Yajulu Medury

Vice-Chancellor- Mahindra University



“

Indira Mahindra School of Education draws spirit and inspiration from the overall vision of the university and positions itself as an instrument for developing global thinkers and leaders in educational research, policy, planning, practice and management.

”

Prof. S. Srinivasa Rao

Dean, Indira Mahindra School of Education



FOCAL POINTS OF THE SCHOOL

Multidisciplinary Orientation

All programs at IMSE are designed to be multidisciplinary in nature. This also ensures that students of the school have the widest possible exposure regarding issues, frameworks and methods.

Diversity

Students at IMSE come from nearly 10 states and from different socio-cultural, economic, and linguistic backgrounds. This diversity enriches the overall atmosphere of the school.

Vibrant Academic Ethos

IMSE is committed to creating a culture of participation and collaboration. We believe that a vibrant and democratic academic ethos both inside and outside the classroom is crucial in developing critical thinking among students.

Teacher – Student Interaction

Teachers at IMSE encourage and practice close student-teacher interactions. Students are always welcomed to interact with the faculty members and discuss academic and other related aspects. There is close mentoring of students by the faculty.

World Class Amenities

IMSE is located on the Mahindra University Campus. It is a residential campus with ample green areas with high-tech smart classrooms, reading rooms, well-equipped and growing library, cafeterias on campus, a medical dispensary and other facilities on the campus itself.

Research Orientation

The curriculum and pedagogy at IMSE are deeply informed and grounded in research. The School makes every effort to integrate the latest scholarship into its courses and classes. The reading materials in each course are updated before the start of every semester to enable incorporation of very recent developments in theoretical, empirical, and practical developments in the field of educational studies. As we adhere to high scholarly standards, our coursework also includes several useful skills that aid our students like academic writing, field work techniques for the development sector, understanding educational data and analysis using qualitative and quantitative techniques etc.

Seminars and Webinars

The seminars held so far have seen guest speakers from TISS, JNU, Delhi University, Ambedkar University, Delhi; Calcutta University, NIEPA, Azim Premji University, University of Hyderabad, University of Bayreuth (Germany), University of Nottingham (UK), Hamilton College, New York; Loyola Marymount University, Los Angeles; William Paterson University of New Jersey, USA, Monash University, Melbourne and other reputed foreign and Indian institutions.

Diverse Specializations of the Faculty

Our faculty have been trained in the best universities in India and abroad and have specialization and research interests in multiple areas including sociology of education, education policy, economics of education, psychology of education, educational governance, curriculum and pedagogy studies, mathematics and science education, history of education, philosophy and political economy of education.

Student Support

All selected PhD students are offered financial support of 30,000 INR as Teaching Assistantships. They are also provided with free board and lodging. Such financial support to the tune of 18,000 INR is also available for deserving candidates joining our MA Education program.

DETAILS OF PROGRAMS

We offer two academic programs - MA Education and PhD in Educational Studies

M.A. Education: Indira Mahindra School of Education (IMSE) at Mahindra University is pioneering a new and exciting approach to a Master's in Education. The MA Program at IMSE combines the training of students in foundational, conceptual and theoretical frameworks along with a wide variety of sectoral, theme and practice-based courses. If you are seeking a Masters' Degree which will enable you to explore diverse career paths, the MA Program at IMSE is your destination.



Core Elements

Courses (core and electives)

- Foundational
- Discipline based
- Sector based
- Theme and Practice based
- A mix of thematic and sector based

Skill/Practice-based modules

- Specific, hands-on module courses

Field Association

- Intensive field experience
- Fieldwork report

Dissertation

- Developing a research problem
- Discussion with review, findings, and analysis
- Presentation

PROGRAM STRUCTURE

The overall course structure for MA includes Core/ mandatory courses (11), elective courses (5), and skill/practice-based modules that involve 2 mandatory courses and a variety of choice-based courses.

In the first semester, the students will take 5 core courses (CC) and 2 practice/skill-based modules (SB) that will all be mandatory, thus providing a much-needed foundation. In the second semester, the students will take 4 core courses (CC), one elective (EC), and two skill-based modules (SB).

The third semester will have 2 core courses (CC), 2 electives (EC) and two or three skill-based modules to choose from. In the fourth semester, students will take two elective courses (EC) and complete dissertation on a topic of their choice.

MA EDUCATION

PROGRAM STRUCTURE AND COURSES

| Sem I | Core/Compulsory | Electives | Modules: Skill/Practice - based |
|--|---|-------------|---|
| <p>(5 Core, 2 Compulsory Modules)</p> <p>20 credits</p> | <ol style="list-style-type: none"> 1. Education in India: Themes & Perspectives (4 Credits) 2. Texts, Institutions and Transformation: A History of Indian Education (3 Credits) 3. Society, Culture and Education (3 Credits) 4. Learner, Learning and Development (3 Credits) 5. Understanding Economy & Education (3 Credits) | <p>None</p> | <p>compulsory</p> <ol style="list-style-type: none"> 1. Introduction to Academic Writing (2 Credits) 2. Understanding and Using Educational Data (2 Credits) |

| Sem II | Core/Compulsory | Electives | Modules: Skill/Practice - based |
|--|---|---|--|
| <p>(4 core, 1 Elective, Choice-based Modules)</p> <p>20 credits</p> | <ol style="list-style-type: none"> 1. Foundations of Social and Educational Research (4 Credits) 2. Educational Ideas and Thought (3 Credits) 3. Children and Childhoods (3 Credits) 4. Education Policy in India (3 Credits) | <p>Sector Based (Select any one)</p> <ol style="list-style-type: none"> 1. School Education (4 Credits) 2. Higher Education (4 Credits) 3. Vocational Education (4 Credits) | <p>Choose any one from the two baskets- 2 credits</p> <ul style="list-style-type: none"> • Educational Planning • Fieldwork Techniques for Development Sector <p>1 credit</p> <ul style="list-style-type: none"> • Visual Ethnography in Education • Scenario planning |

| Sem III | Core/Compulsory | Electives | Modules: Skill/Practice - based |
|---|--|--|--|
| (2 Core, 2 Electives, 2 or 1 choice-based modules) 20 credits | 1. Research Design and Methods (4 Credits) 2. Curriculum and Pedagogy (4 Credits) | Select any two courses (one each from the Thematic and Discipline based basket): Theme Based: (4 Credits) <ol style="list-style-type: none"> Issues in Urban Education Value Education in Changing Societies Gender and Education Diversity, Marginality and Education Mathematics Education Discipline based: (4 Credits) <ol style="list-style-type: none"> History of Science and Technology Education and Research in India (1850-1980) Advanced Sociology of Education: Thinkers, theories and Themes Advanced Economics of Education Advanced Psychology of Education | 2 credits (Compulsory) <ul style="list-style-type: none"> Excel and Stata 1 credit (Choose any two) <ul style="list-style-type: none"> Reading Children's Literature Reading Science Education budget analysis Exploring archives |

| Sem IV | Core/Compulsory | Electives | Modules: Skill/Practice - based |
|--|------------------------|---|--|
| (2 Electives, Dissertation) 20 credits | None | Mixture of Discipline as well as thematic orientations (Select any two): <ol style="list-style-type: none"> Political Economy of Higher Education (4 Credits) Evolution of the Modern University (4 Credits) Feminist Pedagogy (4 Credits) Educational Assessment and Evaluation (4 Credits) | Master's Dissertation (Compulsory): 12 credits |
| Total: 80 Credits | | | |

Note: The Elective courses will keep evolving depending on the faculty strength and interests of students and faculty.

Ph.D in Educational Studies



The Course structure for PhD in Educational Studies consists of five core courses (mandatory), two compulsory skill-based module and three baskets of elective courses including the seminar course. In the First/Fall semester, students are offered three core courses and one compulsory skill-based module. The core courses offered in the Fall semester include 'Research Methods-I', first part of a course on research training to be taught over two semesters. Another core course on "Education in India: Themes and Perspectives" introduces and orients students to the education sector.

One of the core courses to be opted by the students will be in a Major disciplinary area (4 credits) that the student wishes to specialize. Currently, the School offers choices in the disciplines and fields of

- (i) Themes, Theories and Perspectives in Education
- (ii) Economics of Education
- (iii) Sociology of Education
- (iv) History of Education
- (v) Psychology of Education.

Students are required to choose one of these five courses depending on their previous training/interest/choice for specialization. Students are also offered a compulsory skill-based module course on Academic Writing (2 credits).

In the Second/Spring semester, students are offered two core courses, one compulsory skill-based module and will be required to choose two elective courses from three baskets.

The core courses would comprise of

- ▣ Research Methods - II
- ▣ Research and Publication Ethics.

Students will be allowed to choose two electives in the second semester from three baskets. They will be allowed to choose any two baskets out of the three and one course each from the (two) chosen baskets.

- ▣ One basket of elective courses comprises of thematic courses
- ▣ Second on seminar course
- ▣ The third one consists of advanced research methods.

Seminar courses tend to cater to the research interests of students and attempts are made to develop collaborative course(s) to accommodate interests of students not falling in the given list of courses. All courses in the second semester will be of 2 credits.

Ph.D PROGRAM STRUCTURE AND COURSES

| Sem I | Core/Compulsory | Electives | Module/Skill based |
|---|--|---|---|
| (3 Core, 2 Compulsory Modules) 12 credits | 1. Research Methods- I (2 Credits) 2. Education in India: Themes and Perspectives (2 Credits) | None | 1. Introduction to Academic Writing (2 credits, compulsory) |
| | 3. Major Disciplinary Area (4 Credits) -any one of the following: a. Themes, Theories and Perspectives in Education b. Psychology of Education c. Sociology of Education d. History of Education e. Economics of Education | | 2. Understanding and Using Educational data (2 credits, compulsory) |
| Sem II | Core/Compulsory | Electives | Module/Skill based |
| (2 core, 2 Electives) 08 credits | 1. Research Methods- II (2 Credits) 2. Research and Publication Ethics (2 Credits) | Two baskets out of the Three Elective I (Select one out of the following) (2 Credits) <ol style="list-style-type: none"> Education in Multicultural Societies: Concepts, Theories and Themes Mathematics Education Research School Education Education Policy: Economic perspectives Work, Education, and Employment: An Exploration Organizational Climate for Teachers Effectiveness Elective II (Select one out of the following) (2 Credits) <ol style="list-style-type: none"> Advanced Quantitative Research methods Historiography and Methods in History Advanced Qualitative Research Methods Elective III (Seminar Course) (Select one out of the following) (2 Credits) <ol style="list-style-type: none"> Perspectives in Science Teacher Education Ecologies of Higher Education: Knowledge, Institutions and Transformations Critical approaches to Education: Subjectivities, Ideology and Politics | |
| Sem III | Comprehensive Examination/Confirmation of PhD Candidacy | | |
| Sem IV- Sem VI | Thesis | | |
| Total Credits to be earned: 20 | | | |

FACULTY



Dr. S. SRINIVASA RAO
Dean and Professor

Prof. Srinivasa Rao is a Professor of Sociology and Education. He is currently on leave from Jawaharlal Nehru University (JNU) where he is a Professor, and a former Chairperson of Zakir Husain Centre for Educational Studies. His teaching and research interests mainly centre around issues of diversity, equity and social justice; education policy; multiculturalism; and the political economy of urban and education. Prof. Rao has co-edited a volume on 'Sociology of Education in India: Changing Contours and Emerging Concerns' (OUP, 2013). He has served as the President of Comparative Education Society of India (CESI), which is a professional body of education researchers in India. Prof. Rao was also associated with Contemporary Education Dialogue, a Sage Journal of Educational Studies, as its Managing Editor during 2015-2019.



Dr. SHIVALI TUKDEO
Professor

Prof. Shivali Tukdeo is Professor at IMSE and her current research interests include education policy, social transformations, and global educational reforms. She received her PhD in Education Policy Studies (EPS) from the University of Illinois, Urbana Champaign, United States. Prof. Tukdeo worked at the National Institute of Advanced Studies (NIAS), Bengaluru before joining Mahindra University in 2023. Her book 'India Goes to School: Education Policy and Cultural Politics' (Springer, 2019) pays attention to the production, re-formulation and circulation of educational policy ideas in India. Her upcoming research works include an inter-institutional research collaborative on education and urban transformations in India, and a field-driven exploration of the vocational and skill-based education programs in small cities.



Dr. OMPRASAD
Assistant Professor

Dr. Omprasad is an Assistant Professor of History and Education. He was awarded PhD by Jawaharlal Nehru University, New Delhi. Dr. Omprasad teaches courses in the History of Education, the History of Science and Knowledge and Research Methodology. His research interests are in areas of social movements of science and scientists, dynamics of science, society and education relationships, history of knowledge and the changing nature of the university.



Dr. BINAY KUMAR PATHAK

Assistant Professor

Dr. Binay K Pathak is an Assistant Professor in Economics and Education. He obtained his M.Phil. and PhD (Economics of Education) from Jawaharlal Nehru University, New Delhi. Before joining IMSE, he taught Economics at L.N. Mithila University, Darbhanga for five years. He also had stints at reputed think-tanks such as Institute for Defence Studies and Analyses (IDSA) and Centre for WTO Studies (Centre for Research in International Trade), Indian Institute of Foreign Trade (IIFT), New Delhi. At these organizations, he worked on issues related to human security, trade in services and governance. He also had the opportunity to work in multi-disciplinary teams involved with policy communication. He had been part of international collaborations such as "Changing Higher Education in India" sponsored by the British Council of India and coordinated by CGHE, UCL-Institute of Education, London. He had the opportunity to visit Institute of Education, London as a PhD student as part of a research collaboration between Institute of Education (then with the University of London) and JNU, New Delhi for UK-India Education project. He also visited academic institutions in Dhaka for a collaborative project on "Assessing the environment for Social Science Research", sponsored by the Global Development Network. His research interests revolve around issues of development, Economics of Information, education policy, choice and decision making in education, financing and governance in education, higher education, Economics of Knowledge and research ecosystems.



Dr. YERRAMADHA JYOTHI BASUO

Assistant Professor

Dr. Jyothi is presently working as an Assistant Professor at Indira Mahindra School of Education, Mahindra University. She holds a PhD in Education from Osmania University, Hyderabad. Before her current position, Dr. Jyothi had a distinguished tenure as a Principal spanning over more than 6 years at various Colleges of Teacher Education affiliated with Osmania University such as St. Mary's College of Education, Secunderabad. Her professional journey also includes more than 7 years of experience as an Assistant Professor in diverse Teacher Education Institutions.

Dr. Jyothi had the opportunity to be involved in live lessons broadcasted by the State Council of Educational Research and Training (SCERT) on the Satellite Television Channel (T-SAT, Government of Telangana) focusing on enhancing the Pedagogy of Teaching English, thereby benefitting Teacher Training Courses like B.Ed. and D.Ed. Program. Additionally, she is frequently invited to deliver guest lectures at various teacher education colleges. She was actively involved in the "Gandhiji's Nai-Talim Work Education on Experiential Learning and Community Engagement," organized by the Mahatma Gandhi National Council of Rural Education (MGNRCE). Furthermore, she led the organization of a specialized one-day training program focusing on English instruction at CMR International School. She has made significant contributions to the In-Service Teacher Training Program (B.Ed. Program) at the Osmania University. Additionally, she served as an observer and member of the sitting squad for TS EdCET, building strong collaborations with the Department of Education at Osmania University. Her research interests include Philosophy of Education, Pedagogy and Organizational Climate.



Dr. SHIKHA TAKKER
Assistant Professor

Dr. Shikha Takker is an Assistant Professor of Educational Studies, Mahindra University. Her PhD research, from Homi Bhabha Centre for Science Education of Tata Institute of Fundamental Research, has been in mathematics teacher education. She completed her postdoctoral research from University of Witwatersrand, South Africa. Before this, she was teaching at Tata Institute of Social Sciences (TISS) in Hyderabad and earlier at the TISS Mumbai campus. She has coordinated the development of innovative pre-service teacher education programmes to prepare secondary school teachers at TISS Mumbai. Her areas of interest include mathematics education, students' thinking and learning, teacher education, praxis of education, and social learning.



Dr. MIZAJ K V
Assistant Professor

Dr. Mizaj K V is an Assistant Professor of Psychology and Education. She obtained her PhD from Jawaharlal Nehru University, New Delhi. Her areas of interests are in the field of social psychology with a focus on psychological resilience, gender, selfhood and development, and lifelong education. She has been part of two UGC-DAAD projects – one on the transnational circle of support groups for adolescents with autism spectrum disorders (2010-2011), and another on active ageing (2016-2019).

ADMISSION SCHEDULE



Admission Portals for M.A. in Education and PhD are open for the 2025-26 academic year. The academic session for new batches of students begin in early August every year. Prospective students are encouraged to visit our website and utilize contact details (shared here) to get in touch.

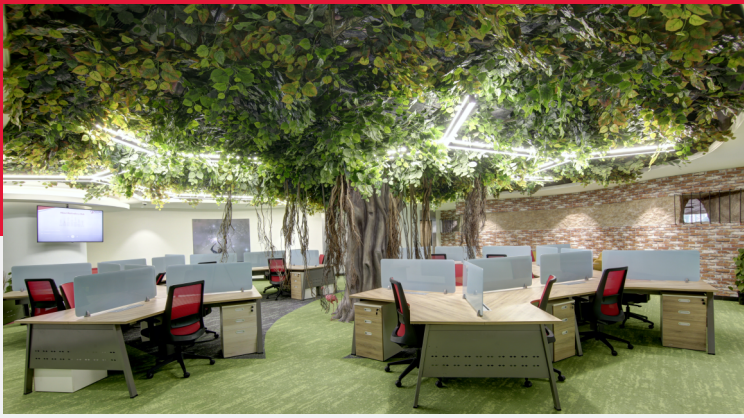

The
MU
CAMPUS



Address: Survey No: 62/1A, Bahadurpally Jeedimetla,
Hyderabad - 500043 - Telangana, INDIA

Email: admissions@mahindrauniversity.edu.in

Website: www.mahindrauniversity.edu.in \ imsoe.outreach@mahindrauniversity.edu.in

Phone: 040 - 6713 5100

SCAN QR
CODE TO
**APPLY
NOW**

